

Ball Valve Full Port & Standard Port

Model #60FBA-F, #60FBA-S

Class 600 ($\frac{1}{2}$ " to 4" Full Port, $1 \frac{1}{2}$ " to 6" Standard Port)

DESIGN SPECIFICATIONS

GENERAL VALVE DESIGN	API 608
PRESSURE TEMPERATURE RATING	ANSI B16.34
WALL THICKNESS	ANSI B16.34
FLANGE DESIGN	ANSI B16.5
FACE TO FACE DIMENSION	ANSI B16.10
MATERIALS	ASTM
VALVE TESTING	API 598

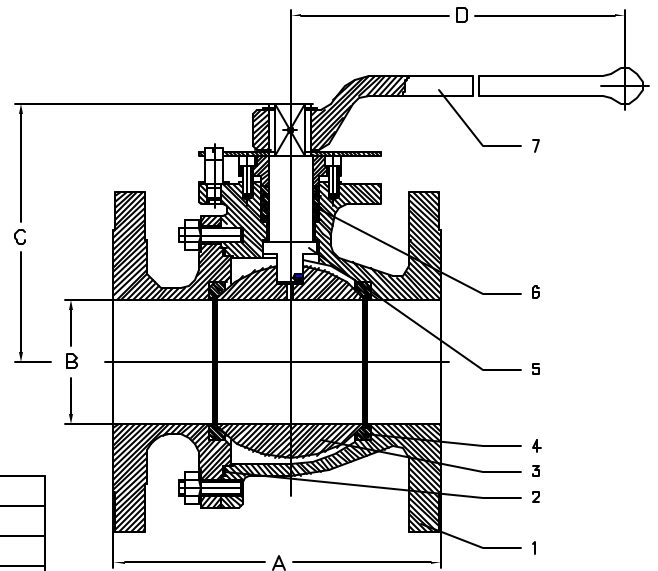

NO.	PART NAME	A 216-WCB	A 351-CF8M
1	BODY	A 216-WCB	A 351-CF8M
2	GASKET	GRAPHITE	PTFE
3	BALL	A 351-CF8M	A 351-CF8M
4	SEAT	RTFE GLASS FILLED 25%	RTFE GLASS FILLED 25%
5	STEM	A 276-316	A 276-316
6	PACKING	GRAPHITE	PTFE
7	HANDLE	A 216-WCB	A 216-WCB

FULL PORT

SIZE	INCH	$\frac{1}{2}$	$\frac{3}{4}$	1	$1\frac{1}{2}$	2	$2\frac{1}{2}$	3	4
	MM	15	20	25	40	50	65	80	100
A	INCH	6.5	7.5	8.5	9.5	11.5	13	14	17
	MM	165	191	216	241	292	330	356	432
B	INCH	0.59	0.79	1	1.5	2	2.5	3	4
	MM	15	20	25	38	51	64	76	102
C	INCH	2.26	2.4	3.44	4.65	5	6.44	6.75	8.35
	MM	57.5	61	87.5	118	129	163.5	171.5	212
D	INCH	5.12	5.12	9	15.75	15.75	36	36	39.37
	MM	130	130	230	400	400	910	910	1000
Weight	LBS	9	12	15	31	43	55	86	187
	KGS	4	6	7	14	20	25	39	85

STANDARD PORT

SIZE	INCH	$1\frac{1}{2}$	2	$2\frac{1}{2}$	3	4	6
	MM	40	50	65	80	100	150
A	INCH	9.5	11.5	13	14	17	22
	MM	241	292	330	356	432	559
B	INCH	1.1	1.5	2	2	3	4
	MM	28	38	50.8	50.8	76	102
C	INCH	3.44	4.64	5	5.85	6.75	8.37
	MM	87.5	118	129	149	171	213
D	INCH	9	15.75	27.5	27.5	36	39.37
	MM	230	400	700	700	910	1000
Weight	LBS	31	40	93	99	183	342
	KGS	14	18	42	45	83	155

