

# Forged Steel Angle Valve

**Class 800 (1/2" to 2")**

NO.	PART NAME	MATERIAL
1	BODY	A105 N
2	SEAT	A276-410 Hard Faced
3	DISC	A276-420
4	STEM	A182-F6A
5	GASKET	Spiral Wound 316+Graphite
6	BONNET	A105 N
7	GLAND PACKING	FLEXIBLE GRAPHITE
8	PIN	A276-410
9	GLAND	A276-420
10	EYEBOLT	A193-B7
11	GLAND FLANGE	A105
12	GLAND NUT	A194-2H
13	STEM NUT	A276-410
14	HANDWHEEL	A197
15	HANDWHEEL NUT	A194-2H
16	BOLT	A193-B7

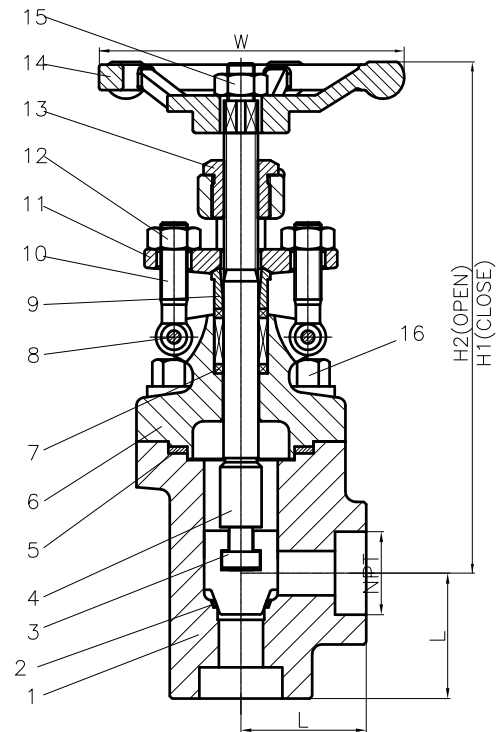

## Class 800

**8ANTFS1 - Threaded**

**8ANWFS1 - Socket Weld**

Size	1/2"	3/4"	1"	1-1/2"	2"
L	1.77	1.77	1.77	2.56	2.91
H1	6.85	6.85	6.85	8.54	9.80
H2	7.28	7.28	7.48	9.37	10.75
W	3.94	3.94	4.92	6.30	7.09
Wt/lbs	6.40	6.60	7.00	13.70	21.30

**Davis forged steel valves comply with the following applicable specifications: ANSI B16.34, ANSI B16.11, ANSI B1.20.1, API602, API606, MSS SP-84, BS5352: Tested to API 598**

**Working Pressure: 1975 psi**

**Body Testing Pressure: 2965 psi**

**Seat Testing Pressure: 2175 psi**

**Air Testing Pressure: 80 psi**

