

**FORGED NEEDLE VALVE**

**6000PSI**

**1/8" to 1"**

**MODEL 6NES - 316  
6NE - A105**

**APPLICABLE STANDARDS:**

- 1.Working Pressure : 6000 psi
- 2.Body Testing Pressure : 9000 psi
- 3.Seat Testing Pressure : 6600 psi
- 4.Air Testing Pressure : 80 psi

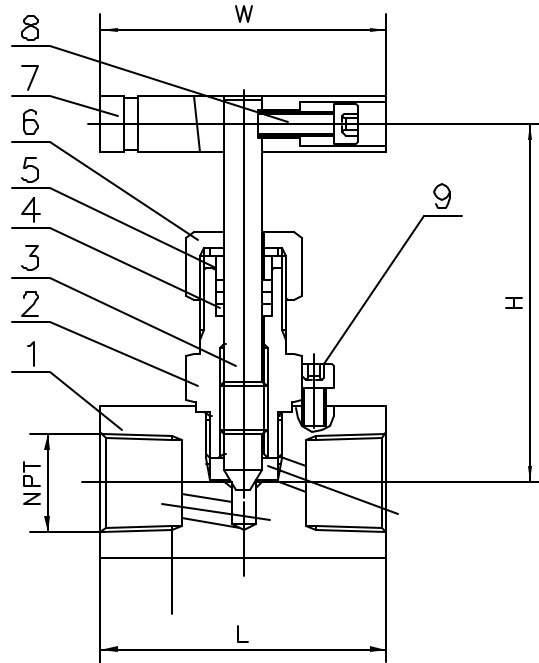

Size	inch	1/8	1/4	3/8	1/2	3/4	1
	mm	3	6	10	13	19	25
L	inch	1.77	1.77	2.36	2.36	2.76	3.15
	mm	45	45	60	60	70	80
H	inch	2.56	2.56	2.95	2.95	3.46	3.74
	mm	65	65	75	75	88	95
W	inch	1.97	1.97	2.36	2.36	3.15	3.15
	mm	50	50	60	60	80	80

NO.	PARTS NAME	F316	A105
1	BODY	F316	A105
2	BONNET	F316	A105
3	STEM	F316	Cr13
4	PACKING	PTFE	PTFE
5	BUSHING	F316	Cr13
6	NUT	F304	STEEL
7	HANDLE	STEEL	STEEL
8	ALLEN NUT	STEEL	STEEL
9	STOP PIN	F304	STEEL

