

Cast Strainer

SW & Threaded Ends

Model # 60WYSW & 60TYSW - WCB

Model # 60WYSF & 60TYSF - 316SS

Class 600 (1/2" to 2")

STANDARD:

Pressure/Temperature Rating: ANSI B16.34

Wall thickness: ANSI B16.34

Connections - ANSI B16.11 for Socket Weld
ANSI B1.20.1 for Threaded

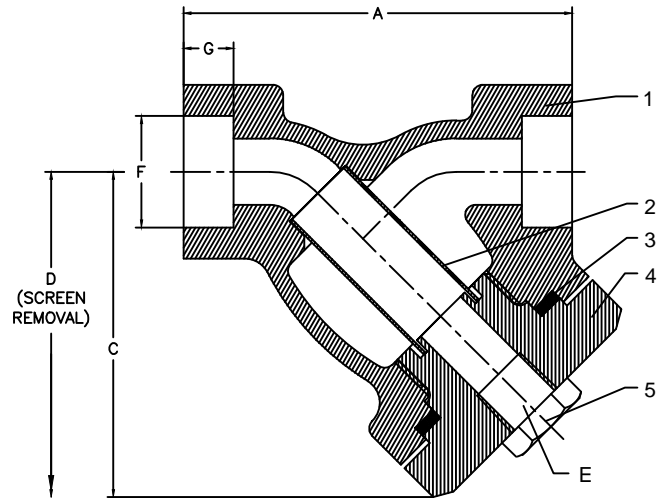

SOCKET WELD END

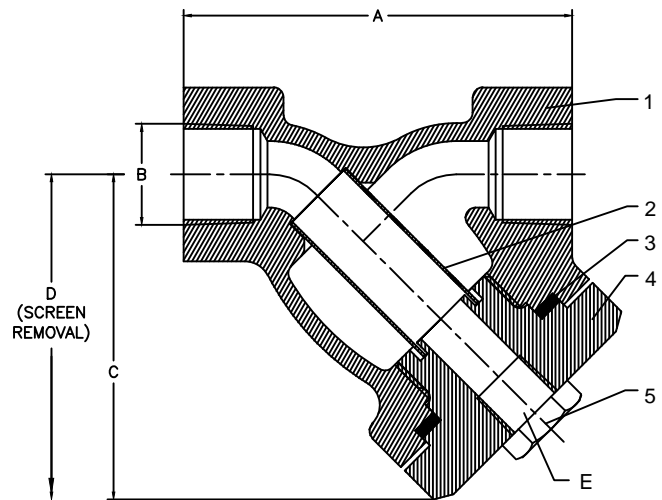

THREADED END

NO.	PART NAME	A 216-WCB	A 351-CF8M
1	BODY	A 216-WCB	A 351-CF8M
2	MESH	A 276-304	A 276-316
3	GASKET	SS 304+GRAPHITE	PTFE
4	COVER	A 216-WCB	CF8M
5	NPT PLUG	SS 304	SS 316

SIZE	INCH	1/2	3/4	1	1-1/4	1-1/2	2
	MM	15	20	25	32	40	50
A	INCH	2.99	3.74	4.61	5	5.63	7.01
	MM	76	95	117	127	143	178
B		1/2-14 NPT	3/4-14 NPT	1-11.5 NPT	1-1/4-11.5 NPT	1-1/2-11.5 NPT	2-11.5 NPT
C	INCH	2.52	2.83	3.7	4.88	4.88	6.06
	MM	64	72	94	124	124	154
D	INCH	2.8	3.23	4.49	6.14	6.14	7.95
	MM	71	82	114	156	156	202
E		1/4-18 NPT	3/8-18 NPT	3/8-18 NPT	3/4-14 NPT	3/4-14 NPT	1-11.5 NPT
F	INCH	0.86	1.07	1.33	1.68	1.92	2.41
	MM	21.8	27.2	33.8	42.7	48.8	61.2
G	INCH	0.39	0.50	0.50	0.5	0.5	0.62
	MM	9.8	12.8	12.8	12.8	12.8	15.8

